

THE SOUTHEND BOROUGH COUNCIL (WAITING, LOADING AND STOPPING AND PARKING PLACES) (MAP BASED) (CONSOLIDATION) ORDER 2021

THE SOUTHEND-ON-SEA CITY COUNCIL (WAITING, LOADING, STOPPING AND PARKING PLACES) (MAP BASED) (BEACH AVENUE) AMENDMENT NO.12 ORDER 2025

THE SOUTHEND-ON-SEA CITY COUNCIL (WAITING, LOADING, STOPPING AND PARKING PLACES) (MAP BASED) (MANOR ROAD) AMENDMENT NO.13 ORDER 2025

THE SOUTHEND-ON-SEA CITY COUNCIL (WAITING, LOADING, STOPPING AND PARKING PLACES) (MAP BASED) (BLATCHES CHASE AND WHITEHOUSE ROAD JUNCTION) AMENDMENT NO.14 ORDER 2025

THE SOUTHEND-ON-SEA CITY COUNCIL (WAITING, LOADING, STOPPING AND PARKING PLACES) (MAP BASED) (TERMINAL CLOSE / SHOEBURY AVENUE JUNCTION) AMENDMENT NO.15 ORDER 2025

Notice is hereby given that Southend-on-Sea City Council (hereinafter referred to as “the Council”) in exercise of its powers under Sections 1, 2, 4, and 122 of the Road Traffic Regulation Act 1984 , and of all other enabling powers, and after consultation with the Chief Officer of Police in accordance with Part III and Part IV of Schedule 9 to the 1984 Act has made the following Orders:

- The Southend-on-Sea City Council (Waiting, Loading, Stopping and Parking Places) (Map-Based) (Beach Avenue) Amendment No.12 Order 2025
- The Southend-on-Sea City Council (Waiting, Loading, Stopping and Parking Places) (Map-Based) (Manor Road) Amendment No.13 Order 2025
- The Southend-on-Sea City Council (Waiting, Loading, Stopping and Parking Places) (Map-Based) (Blatches Chase and Whitehouse Road Junction) Amendment No.14 Order 2025
- The Southend-on-Sea City Council (Waiting, Loading, Stopping and Parking Places) (Map-Based) (Terminal Close / Shoebury Avenue Junction) Amendment No.15 Order 2025

The effect of the Traffic Regulation Orders (TRO) will be to:

PTO1139 – Beach Avenue

To amend the current No Waiting, 8am – 6pm, (single yellow line) restrictions to No Waiting, Monday – Friday, 10am – 4pm, within Beach Avenue on the west side of the road, from the property boundary of No.113 and No.115 to its junction with Leigh Road.

PTO1140 – Manor Road

To introduce 8.8 metres of No Waiting at Any Time (double yellow line) restrictions, at the northern entrance to the flats on Manor Road.

PTO1059 – Blatches Chase / Whitehouse Road Junction

At the junction of Blatches Chase and Whitehouse Road, introduce No Waiting at Any Time (double yellow lines) restrictions. The measurements are as follows; on the west side of the road, 28 metres west and 10 metres north; on the east side of the road, 10 metres east and 10 metres north.

PTO1110 – Terminal Close / Shoebury Avenue Junction

To extend the current restrictions at the junction of Terminal Close and Shoebury Avenue to 10 metres on both sides, and to extend the current restrictions opposite the junction of Terminal Close and Shoebury Avenue on the east side by 5 metres.

These changes will amend the following Order: The Southend Borough Council (Waiting, Loading and Stopping and Parking Places) (Map Based) (Consolidation) Order 2021 (as amended) (to be known as ‘The 2021 Order’). The remainder of ‘The 2021 Order’ will remain in full force and effect. Map-based Schedules to replace plans in the appropriate schedule of ‘The 2021 Order’ (as amended). The amendment shall come into operation on 21st August 2025 and may be cited as:

The Southend Borough Council (Waiting, Loading, Stopping and Parking Places) (Map Based) (Consolidation) Order 2021:

- The Southend-on-Sea City Council (Waiting, Loading, Stopping and Parking Places) (Map-Based) (Beach Avenue) Amendment No.12 Order 2025
- The Southend-on-Sea City Council (Waiting, Loading, Stopping and Parking Places) (Map-Based) (Manor Road) Amendment No.13 Order 2025
- The Southend-on-Sea City Council (Waiting, Loading, Stopping and Parking Places) (Map-Based) (Blatches Chase and Whitehouse Road Junction) Amendment No.14 Order 2025
- The Southend-on-Sea City Council (Waiting, Loading, Stopping and Parking Places) (Map-Based) (Terminal Close / Shoebury Avenue Junction) Amendment No.15 Order 2025

Copies of the Order, which will come into operation on 21st August 2025, the statement of reasons for making the Order and plans showing the affected streets can be inspected during normal office hours, inclusive for a period of six weeks from the date on which the Orders were made:

- On the Councils Website using this link <https://www.southend.gov.uk/tro>
- At the Civic Centre, Victoria Avenue, Southend-on-Sea, SS2 6ER.

Any person desiring to question the validity of the Orders or of any provision contained therein on the grounds that it is not within the powers of the relevant section of the Road Traffic Regulation Act 1984, or that any of the relevant requirements thereof or of any relevant regulations made thereunder has not been complied with may, within six weeks from the date on which the Orders were made, make an application for the purpose to the High Court.

Date: 20th August 2025

THE SOUTHEND BOROUGH COUNCIL (WAITING, LOADING, STOPPING AND PARKING PLACES) (MAP BASED) (CONSOLIDATION) ORDER 2021

THE SOUTHEND-ON-SEA CITY COUNCIL (WAITING, LOADING, STOPPING AND PARKING PLACES) (MAP BASED) (TERMINAL CLOSE/SHOEBURY AVENUE JUNCTION) AMENDMENT NO.15 ORDER 2025

Southend-on-Sea City Council in exercise of its powers under Sections 1, 2, 4 and 122 under the Road Traffic Regulation Act 1984 (as amended) ("the 1984 Act") and the Traffic Management Act 2004 ("the 2004 Act") and of all other enabling powers, and after consultation with the Chief Officer of Police in accordance with Part III and Part IV of Schedule 9 to the 1984 Act, hereby makes the following Order:

1. Without prejudice to the validity of anything done or to the liability incurred in respect of any act or omission before the coming into operation of this Order, The Southend Borough Council (Waiting, Loading, Stopping and Parking Places) (Map Based) (Consolidation) Order 2021 (as amended) (To be known as 'The 2021 Order') shall have effect as though;
 - (i) The items represented on the plans in Schedule 1 to this Order shall replace those corresponding plans as listed in the appropriate Schedule to The 2021 Order (as amended).
2. The effect of this Order is to (this article is an explanatory note this is not part of the Order):
 - To extend the current restrictions at the junction of Terminal Close and Shoebury Avenue to 10 metres on both sides.
 - To extend the current restrictions opposite the junction of Terminal Close and Shoebury Avenue on the east side by 5 metres.
3. The remainder of The Southend Borough Council (Waiting, Loading, Stopping and Parking Places) (Map Based) (Consolidation) Order 2021 (as amended) shall remain in full force and effect.
4. This Order shall come into effect on the 21st day of August 2025 and may be cited as:
"The Southend Borough Council (Waiting, Loading, Stopping and Parking Places) (Map Based) (Consolidation) Order 2021.
The Southend-on-Sea City Council (Waiting, Loading, Stopping and Parking Places) (Map-Based) (Terminal Close/Shoebury Avenue Junction) Amendment No.15 Order 2025".

Given under the Common Seal of Southend-on-Sea City Council the 20th day of August 2025.

The COMMON SEAL of)
SOUTHEND-ON-SEA CITY)
COUNCIL was pursuant to a)
resolution of the Council)
hereunto affixed in the)
presence of:)

A handwritten signature in black ink, appearing to read 'L. Delahunty', is written over a grey rectangular background.

L. Delahunty
Proper Officer of the Council

Schedule 1

Map-based Schedules to replace plans in the appropriate schedule of The 2021 Order (as amended)

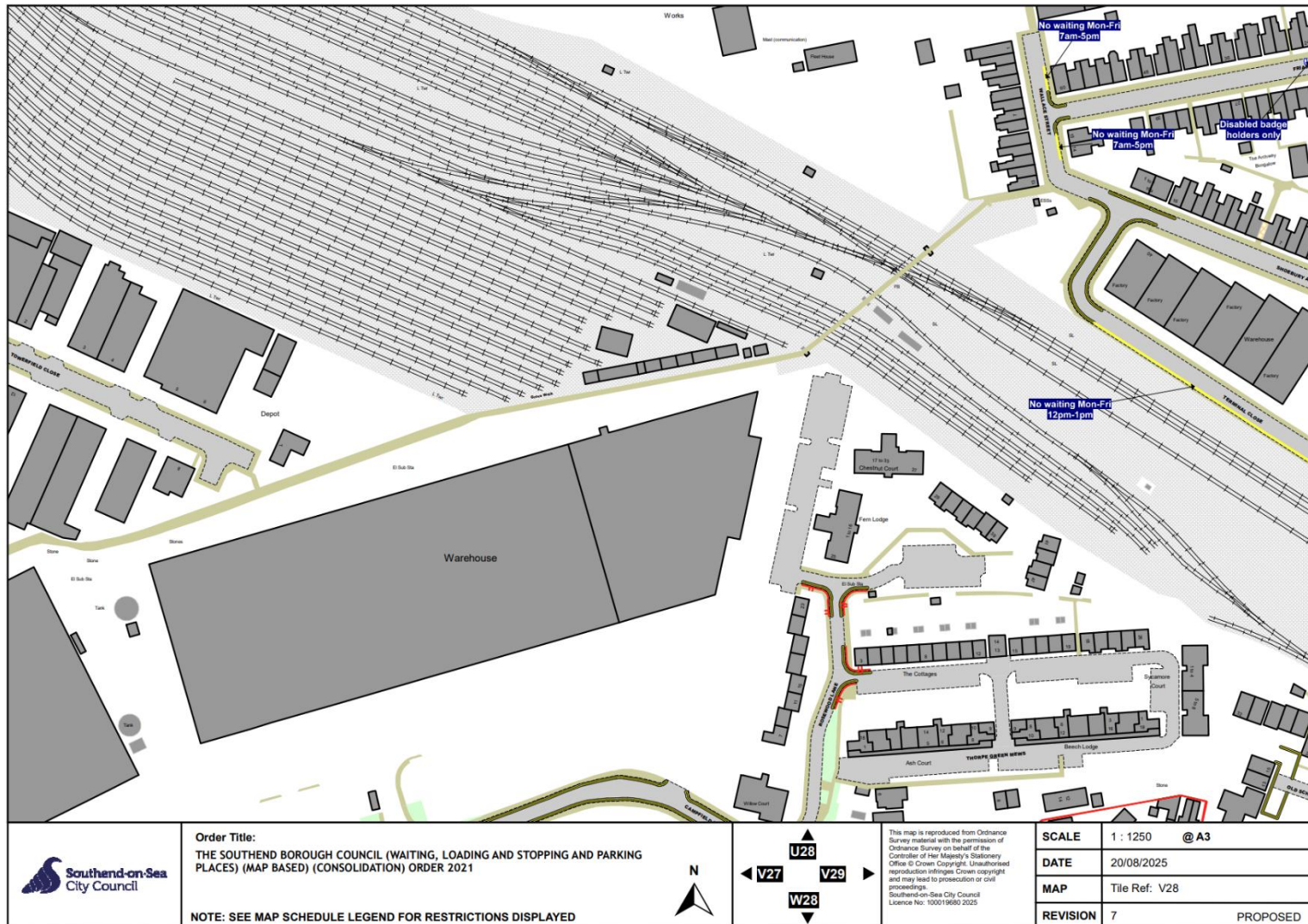

THE SOUTHEND BOROUGH COUNCIL (WAITING, LOADING, STOPPING AND PARKING PLACES) (MAP BASED) (CONSOLIDATION) ORDER 2021

THE SOUTHEND-ON-SEA CITY COUNCIL (WAITING, LOADING, STOPPING AND PARKING PLACES) (MAP BASED) (WINDERMERE ROAD)
AMENDMENT NO.* ORDER 2025

THE SOUTHEND-ON-SEA CITY COUNCIL (WAITING, LOADING, STOPPING AND PARKING PLACES) (MAP BASED) (TERMINAL CLOSE/SHOEBURY AVENUE JUNCTION) AMENDMENT NO.* ORDER 2025

THE SOUTHEND-ON-SEA CITY COUNCIL (WAITING, LOADING, STOPPING AND PARKING PLACES) (MAP BASED) (COMET WAY OUTSIDE NO.7)
AMENDMENT NO.* ORDER 2025

THE SOUTHEND-ON-SEA CITY COUNCIL (WAITING, LOADING, STOPPING AND PARKING PLACES) (MAP BASED) (LONDON ROAD)
AMENDMENT NO.* ORDER 2025

Southend-on-Sea City Council (hereinafter referred to as “the Council”) in exercise of its powers under Sections 1, 2, 4 and 122 under the Road Traffic Regulation Act 1984 (as amended) (“the 1984 Act”) and the Traffic Management Act 2004 (“the 2004 Act”) and of all other enabling powers, and after consultation with the Chief Officer of Police in accordance with Part III and Part IV of Schedule 9 to the 1984 Act, hereby give notice that it intends to make the following Amendment Order:

- The Southend-on-Sea City Council (Waiting, Loading, Stopping and Parking Places) (Map-Based) (Windermere Road) Amendment No.* Order 2025
- The Southend-on-Sea City Council (Waiting, Loading, Stopping and Parking Places) (Map-Based) (Terminal Close/Shoebury Avenue junction) Amendment No.* Order 2025
- The Southend-on-Sea City Council (Waiting, Loading, Stopping and Parking Places) (Map-Based) (Comet Way outside No.7) Amendment No.* Order 2025
- The Southend-on-Sea City Council (Waiting, Loading, Stopping and Parking Places) (Map-Based) (London Road) Amendment No.* Order 2025

The effect of the Traffic Regulation Orders(TRO) would be to:

PTO1126 – Windermere Road

- To introduce 5 metres of No Waiting at Any Time (double yellow lines) restrictions on the east side of Windermere Road, between the two existing School Keep Clear restrictions.

PTO1110 – Terminal Close / Shoebury Avenue Junction

- To extend the current restrictions at the junction of Terminal Close and Shoebury Avenue to 10 metres on both sides.
- To extend the current restrictions opposite the junction of Terminal Close and Shoebury Avenue on the east side by 5 metres.

PTO1111 – Comet Way outside No.7

- To introduce approximately 45 metres of No Waiting at Any Time (double yellow lines) restrictions on the east side of Comet Way outside No.7.

PTO1125 – London Road parking bay amendments

- To reduce the length of the No Waiting at Any Time (double yellow lines) to 10 metres on the east side of Canvey Road, Sydney Road, Leigh Gardens and Barnard Road at their junctions with the North side of London Road.
- To reduce the length of the No Waiting at Any Time (double yellow lines) to 10 metres on the east side of Sydney Road, Canvey Road, Leigh Gardens and Barnard Road at their junctions with the south side of London Road.

- To introduce Limited Waiting bays (8am-6pm, 2hrs no return within 4hrs) on London Road at the following locations:
 - x2 bays outside No.1378 – No.1380
 - x1 bay outside No.1621
 - x1 bay outside No.1354
 - x1 bay outside No.1344
 - x1 bay outside No.1583

Copies of the Notice of Proposal, proposed draft Amendment Orders, the Statement of Reasons for proposing to make the Order and designs showing the proposals can be inspected;

- At the Civic Centre, Victoria Avenue, Southend-on-Sea, SS2 6ER,
- Online via our map based Order system, TraffWeb App using the following link: <https://southend.traffweb.app>, and
- Online via the Councils website using the following link <https://www.southend.gov.uk/tro>

The public consultation period, will be live from 28th April 2025 until 19th May 2025.

Any persons desiring to make a comment on the proposals, only within the given dates, can do so by: making a comment on TraffWeb system under 'Public Consultation' using the following link, <https://southend.traffweb.app/traffweb/2/PublicConsultation>, or by emailing traffweb@southend.gov.uk, or stating the grounds thereof in writing addressed to the TRO Team to the address stated above. The following scheme references must be quoted:

- *PTO1126 – Windermere Road*
- *PTO1110 – Terminal Close / Shoebury Avenue Junction*
- *PTO1111 – Comet Way outside No.7*
- *PTO1125 – London Road parking bay amendments*

The changes for on-street parking will amend the following Order;
The Southend Borough Council (Waiting, Loading, Stopping and Parking Places) (Map Based) (Consolidation) Order 2021

Date: 28th April 2025

Statement of Reason

THE SOUTHEND-ON-SEA CITY COUNCIL (WAITING, LOADING, STOPPING AND PARKING PLACES) (MAP BASED) (TERMINAL CLOSE/SHOEBURY AVENUE JUNCTION) AMENDMENT NO.15 ORDER 2025

Proposal

The proposal is to:

- To extend the current restrictions at the junction of Terminal Close and Shoebury Avenue to 10 metres on both sides.
- To extend the current restrictions opposite the junction of Terminal Close and Shoebury Avenue on the east side by 5 metres.

Reasons

Following a resident complaint regarding HGV movements in Terminal Close, an engineer review was undertaken. Terminal Close, an industrial area and dead-end street, is accessed solely via Shoebury Avenue, a residential street. The complaint highlighted concerns about HGVs driving onto pavements and occasionally into private driveways to manoeuvre. The engineer review identified that these issues were caused by the tight area and parked vehicles, which limit the space available at the junction for HGVs to manoeuvre safely.

Road Traffic Regulation Act 1984

The sections which the City Council are using for the implementation of the proposed scheme as above are 1, 2, 4 and 122. The grounds that encompassed the reason for these proposals in Section 1 of the Road Traffic Regulation Act 1984 are:

- (a) for avoiding danger to persons or other traffic using the road or any other road or for preventing the likelihood of any such danger arising, or
- (b) for preventing damage to the road or to any building on or near the road, or
- (c) for preserving or improving the amenities of the area through which the road runs.

In addition, thorough consideration was given to the factors set out in Section 122 of the Road Traffic Regulation Act 1984 in proposing this scheme.

Traffic Signs Regulations and General Directions 2016

All of the associated signing and lining will be in accordance with Traffic Signs Regulations and General Directions (TSRGD) 2016.

Equality Act 2010

Thorough consideration was given to the equalities duty of Southend-on-Sea City Council under Section 149 of the Equality Act 2010.

Due Regard for Traffic Orders and Notices

The Southend-on-Sea City Council has a duty to give 'due regard to' the following three aims of the public sector equality duty (section 149 of the Equality Act 2010) during the development of the policy.

- Eliminate discrimination, harassment and victimisation and any other conduct prohibited by the ACT:
- Advance equality of opportunity between people who share a protected characteristic and people who do not share it; and
- Foster good relations between people who share a protected characteristic

An initial assessment against each of the protected groups is provided below – any issues highlighted through the consultation process will be considered and reported at the end of the consultation period.

Proposal	<ul style="list-style-type: none"> • To extend the current restrictions at the junction of Terminal Close and Shoebury Avenue to 10 metres on both sides. • To extend the current restrictions opposite the junction of Terminal Close and Shoebury Avenue on the east side by 5 metres.
Notice/ Traffic Order Title	<p>THE SOUTHEND BOROUGH COUNCIL (WAITING, LOADING, STOPPING AND PARKING PLACES) (MAP BASED) (CONSOLIDATION) ORDER 2021</p> <p>THE SOUTHEND-ON-SEA CITY COUNCIL (WAITING, LOADING, STOPPING AND PARKING PLACES) (MAP BASED) (TERMINAL CLOSE/SHOEBURY AVENUE JUNCTION) AMENDMENT NO.15 ORDER 2025</p>

Protected group	Challenge or opportunity considered and what we did
Age(A)	No negative or positive impact on this group has been identified at this time.
Disability (D)	<p>No negative or positive impact on this group has been identified at this time.</p> <p>Blue badge holders have certain concessions to park on certain restrictions, free of charge, when displaying a valid blue badge, as follows;</p> <ul style="list-style-type: none"> • Disabled bays on roadside or in car parks (for up to the period indicated on the adjacent sign) • Any roadside pay-by-phone or pay-and-display bays (free of charge)

	<ul style="list-style-type: none"> Any council-owned car park where pay-by-phone or pay-and-display is in use (free of charge) Up to three hours on single or double yellow lines, where there is no loading/unloading restriction. (Blue badge and clocks must be displayed). <p>Additional blue badge bay provision located close to local facilities to improve access.</p>
Sex (S)	No negative or positive impact on this group has been identified at this time.
Race (including Gypsy & Traveller) (R))	No negative or positive impact on this group has been identified at this time.
Gender reassignment (GR)	No negative or positive impact on this group has been identified at this time.
Marriage & civil partnership (MCP)	No negative or positive impact on this group has been identified at this time.
Pregnancy & maternity (PM)	No negative or positive impact on this group has been identified at this time.
Religion and/or Belief (RAOB)	No negative or positive impact on this group has been identified at this time.
Sexual Orientation (SO)	No negative or positive impact on this group has been identified at this time.

Name: **C. Read**

Head of Highways and Coastal

Dated: 20th August 2025

Monitoring and Review

Please identify any aspects that require reconsideration following the TRO consultation process, identify any amendments made in relation to due regard and give reasoning.

Name: **C. Read**

Head of Highways and Coastal

Dated: 20th August 2025

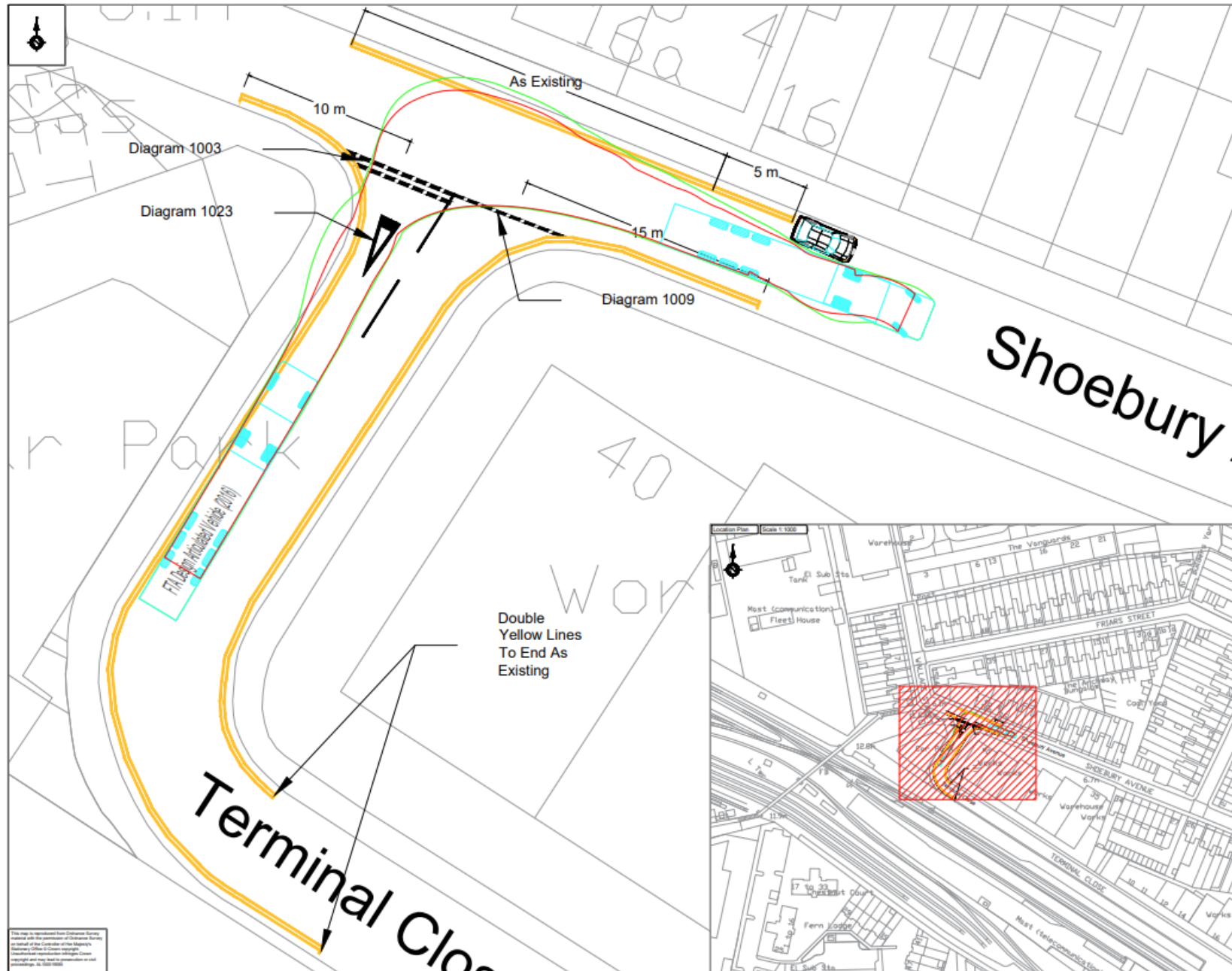

This map is reproduced from Ordnance Survey material with the permission of Ordnance Survey on behalf of the Controller of the Map. The Ordnance Survey name is used under license. All other names are the property of their respective owners. Copyright and map test for reproduction or sale prohibited. 00-000000

SAFETY, HEALTH AND ENVIRONMENTAL INFORMATION	
In addition to the hazards/risks normally associated with the types of work shown on the drawing, note the following significant residual risks:	
Access	None
Excavation /	None
Drilling	None
Site	None
Access	None
Access	None

Key:	
1. Area of Interest	
2. Double Yellow Line	
3. Give Way Markings	

Notes:

- Setting out on site to be agreed with SCC Engineer before works commence
- Do not scale. This drawing must be read in conjunction with all other contract drawings and associated documents if available.
- All works must comply with the Department of Transport Specification for Highway Works and associated Standard Construction Drawings.
- All traffic signs and road markings must conform to the Traffic Signs Regulations and General Directions 2016 (TSRGD).
- Unless otherwise specified, road markings must be applied as thermoplastic screw with solid glass beads for reflectivity.
- Length of proposed double yellow line as indicated on plan.
- Remove existing and bar.
- All yellow markings to be 75mm in width.

No setting in any line

Vehicle Dimensions (mm)

Parameter	Value
Overall Length	12000
Overall Width	2500
Wheelbase	4000
Max. Height	4000
Max. Width	2500

Rev	Description	Auth	Date
1	Issue for Construction	AAZ	27/11/2024

Southend-on-Sea City Council
Infrastructure and Environment
PO Box 5560, Civic Centre
Victoria Avenue, Southend-on-Sea, SS2 6ZQ

Project Title
Junction Protection
Proposed Plan
Terminal Close

Drawing Title
Terminal Close

Drawn	Date	Review	Date
AAZ	27/11/2024	AAZ	27/11/2024

Checked	Date	Approved	Date
AAZ	27/11/2024	AAZ	27/11/2024

Scale @ A1: 1:100

Drawing Status: Preliminary

Drawing Number: SCC11089-100-SCC-HMW-TC-MD-SM-SK082