

THE SOUTHEND-ON-SEA CITY COUNCIL (VARIOUS ROADS) (MOVING TRAFFIC AND SPEED LIMIT) ORDER 2025

THE SOUTHEND-ON-SEA CITY COUNCIL (VARIOUS ROADS) (MOVING TRAFFIC AND SPEED LIMIT) (20MPH SPEED LIMITS – SOUTHCHURCH PARK) AMENDMENT NO.* ORDER 2026

Southend-on-Sea City Council (hereinafter referred to as “the Council”) in exercise of its powers under Sections 84, 85 and 124 under the Road Traffic Regulation Act 1984 (as amended) (“the 1984 Act”) and the Traffic Management Act 2004 (“the 2004 Act”) and of all other enabling powers, and after consultation with the Chief Officer of Police in accordance with Part III and Part IV of Schedule 9 to the 1984 Act, hereby give notice that it intends to make the following Amendment Orders:

- The Southend-on-Sea City Council (Various Roads) (Moving Traffic and Speed Limit) (20MPH Speed Limits – Southchurch Park) Amendment No.* Order 2026

The effect of the Order will be to introduce 20mph Speed Limits in the following roads:

Road Name	Extent
Kensington Road	From its junction with Shaftesbury Avenue to its junction with Northumberland Crescent
Shaftesbury Avenue	From its junction with Kensington Road to its junction with Lifstan Way
Lifstan Way	From its junction with Shaftesbury Avenue to its junction with Woodgrange Drive
Northumberland Crescent	From its junction with Lifstan Way to its junction with Kensington Road

A copy of the Notice of Intent (NOI), draft Amendment Order, the Statement of Reasons (SoR) and designs showing the proposals can be inspected:

- Online via our map-based Order system, TraffWeb App using the following link: <https://southend.traffweb.app>,
- Online via the Councils website using the following link, under the ‘Moving and Speed Orders - Public Consultation’ heading: <https://www.southend.gov.uk/transport-policies-traffic-regulation-orders/traffic-regulation-orders-consultations/2> and,
- At the Civic Centre Reception, Victoria Avenue, Southend-on-Sea, SS2 6ER.

The public consultation period will be live from 13th May 2026 until 3rd June 2026. Any persons desiring to make a comment on the proposals, only within the given dates, can do so by: making a comment on TraffWeb system under ‘Public Consultation’ using the following link, <https://southend.traffweb.app/traffweb/2/PublicConsultation>, or by emailing traffweb@southend.gov.uk, or stating the grounds thereof in writing addressed to the Traffic Management Team to the address stated above. The following scheme reference must be quoted *PTO1312 – 20MPH Speed Limits – Southchurch Park*.

All written representations received concerning Speed Amendment Orders are public documents that may be inspected by any person on demand.

The changes will amend the following Order; ‘The Southend-on-Sea City Council (Various Roads) (Moving Traffic and Speed Limit) Order 2025’. A copy of this Consolidation Order, can be found online using the following link, under the ‘Consolidation Orders’ heading: <https://www.southend.gov.uk/transport-policies-traffic-regulation-orders/traffic-regulation-orders-consultations/2>

Date: 13th May 2026

THE SOUTHEND-ON-SEA CITY COUNCIL (VARIOUS ROADS) (MOVING TRAFFIC AND SPEED LIMIT) ORDER 2025

THE SOUTHEND-ON-SEA CITY COUNCIL (VARIOUS ROADS) (MOVING TRAFFIC AND SPEED LIMIT) (20MPH SPEED LIMITS – SOUTHCHURCH PARK) AMENDMENT NO.* ORDER 2026

The Southend-on-Sea City Council, in exercise of its powers under Sections 84, 85 and 124 (and parts I, II and IV of Schedule 9) of the Road Traffic Regulation Act 1984 (“the Act”) as amended and the Traffic Management Act 2004 as amended and of all other enabling powers, and having regard to Section 122 of the Act after consultation with the Chief Officer of Police in accordance with Part III of Schedule 9 of the Act, hereby makes the following Order:

1. Without prejudice to the validity of anything done or to the liability incurred in respect of any act or omission before the coming into operation of this Order THE SOUTHEND-ON-SEA CITY COUNCIL (VARIOUS ROADS) (MOVING TRAFFIC AND SPEED LIMIT) ORDER 2025 (To be known as ‘The 2025 Order’) and shall have effect;
 - (i) The items represented on the plans in Schedule 1 to this Order shall replace those plans as listed in the appropriate Schedule to The 2025 Order (as amended).
2. The effect of this Order is to (this article is an explanatory note and is not part of the Order):
 - (a) Introduce 20mph Speed Limits in the following roads:

Road Name	Extent
Kensington Road	From its junction with Shaftesbury Avenue to its junction with Northumberland Crescent
Shaftesbury Avenue	From its junction with Kensington Road to its junction with Lifstan Way
Lifstan Way	From its junction with Shaftesbury Avenue to its junction with Woodgrange Drive
Northumberland Crescent	From its junction with Lifstan Way to its junction with Kensington Road

3. The remainder of THE SOUTHEND-ON-SEA CITY COUNCIL (VARIOUS ROADS) (MOVING TRAFFIC AND SPEED LIMIT) ORDER 2025 (as amended) shall remain in full force and effect.
4. This Order shall come into effect on ***** and may be cited as “THE SOUTHEND-ON-SEA CITY COUNCIL (VARIOUS ROADS) (MOVING TRAFFIC AND SPEED LIMIT) ORDER 2025 THE SOUTHEND-ON-SEA CITY COUNCIL (VARIOUS ROADS (MOVING TRAFFIC AND SPEED LIMIT) (20MPH SPEED LIMITS – SOUTHCHURCH PARK) AMENDMENT NO.* ORDER 2026”.

Given under the Common Seal of Southend-on-Sea City Council the XX day of XXXX 202X.

The COMMON SEAL of)
SOUTHEND-ON-SEA CITY)
COUNCIL was pursuant to a)
resolution of the Council)
hereunto affixed in the)
presence of:)

Proper officer of the Council

Schedule 1

Map-based Schedules to replace plans (W21 rv0, W20 rev0, V21 rev0, V20 rev0, U21 rev0) in the appropriate Schedule of The 2025 Order (as amended)

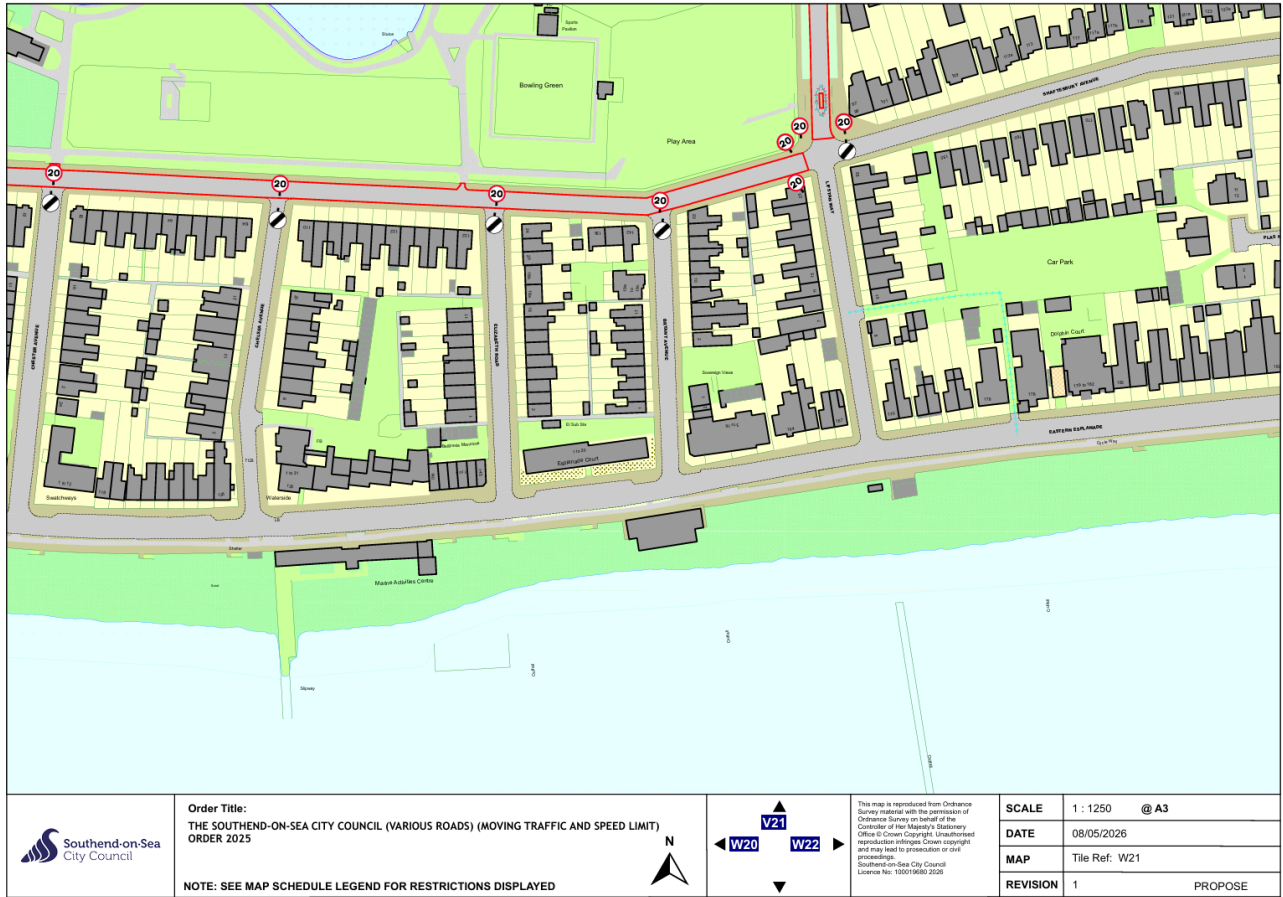



	Order Title: THE SOUTHEND-ON-SEA CITY COUNCIL (VARIOUS ROADS) (MOVING TRAFFIC AND SPEED LIMIT) ORDER 2025		This map is reproduced from Ordnance Survey material with the permission of Ordnance Survey on behalf of the Controller of Her Majesty's Stationery Office © Crown Copyright. Unauthorised reproduction infringes Crown copyright and may lead to prosecution or civil proceedings. Southend-on-Sea City Council Licence No: 100019689 2026	SCALE 1 : 1250 @ A3
	NOTE: SEE MAP SCHEDULE LEGEND FOR RESTRICTIONS DISPLAYED			DATE 08/05/2026
				MAP Tile Ref: W20
				REVISION 1 PROPOSE



	Order Title: THE SOUTHEND-ON-SEA CITY COUNCIL (VARIOUS ROADS) (MOVING TRAFFIC AND SPEED LIMIT) ORDER 2025		This map is reproduced from Ordnance Survey material with the permission of Ordnance Survey on behalf of the Controller of Her Majesty's Stationery Office © Crown Copyright. Unauthorised reproduction infringes Crown copyright and may lead to prosecution or civil proceedings. Southend-on-Sea City Council Licence No: 100019689 2026	SCALE 1 : 1250 @ A3
	NOTE: SEE MAP SCHEDULE LEGEND FOR RESTRICTIONS DISPLAYED			DATE 08/05/2026
				MAP Tile Ref: V21
				REVISION 1 PROPOSE



Order Title:
**THE SOUTHEND-ON-SEA CITY COUNCIL (VARIOUS ROADS) (MOVING TRAFFIC AND SPEED LIMIT)
 ORDER 2025**



NOTE: SEE MAP SCHEDULE LEGEND FOR RESTRICTIONS DISPLAYED



This map is reproduced from Ordnance Survey material with the permission of Ordnance Survey on behalf of the Controller of Her Majesty's Stationery Office © Crown Copyright. Unauthorised reproduction infringes Crown copyright and may lead to prosecution or civil proceedings.
 Southend-on-Sea City Council
 Licence No: 100019490/2025

SCALE	1 : 1250 @ A3
DATE	08/05/2026
MAP	Title Ref: V20
REVISION	1 PROPOSE



Order Title:
THE SOUTHEND-ON-SEA CITY COUNCIL (VARIOUS ROADS) (MOVING TRAFFIC AND SPEED LIMIT)
ORDER 2025



NOTE: SEE MAP SCHEDULE LEGEND FOR RESTRICTIONS DISPLAYED



This map is reproduced from Ordnance Survey material with the permission of Ordnance Survey on behalf of the Controller of Her Majesty's Stationery Office © Crown Copyright. Unauthorised reproduction infringes Crown copyright and may lead to prosecution or civil proceedings.
 Southend-on-Sea City Council
 Licence No: 100019682 2026

SCALE	1 : 1250 @ A3
DATE	08/05/2026
MAP	Tile Ref: U21
REVISION	1 PROPOSE

Statement of Reasons

THE SOUTHEND-ON-SEA CITY COUNCIL (VARIOUS ROADS) (MOVING TRAFFIC AND SPEED LIMIT) ORDER 2025

THE SOUTHEND-ON-SEA CITY COUNCIL (VARIOUS ROADS) (MOVING TRAFFIC AND SPEED LIMIT) (20MPH SPEED LIMITS – SOUTHCHURCH PARK) AMENDMENT NO.* ORDER 2026

Proposals

The extent of the proposed scheme is the west area Greenways Primary School and around Southchurch Park; Kensington Road, Shaftesbury Avenue, Lifstan Way and Northumberland Crescent.

The proposed scheme will introduce 20mph Speed Limits with the associated speed limit signage and road markings on the following roads:

Road Name	Extent
Kensington Road	From its junction with Shaftesbury Avenue to its junction with Northumberland Crescent
Shaftesbury Avenue	From its junction with Kensington Road to its junction with Lifstan Way
Lifstan Way	From its junction with Shaftesbury Avenue to its junction with Woodgrange Drive
Northumberland Crescent	From its junction with Lifstan Way to its junction with Kensington Road

Reasons

Department for Transport Circular 01/2013 which was revised in March 2024.– ‘Setting local speed limits’, provides guidance on speed control measures in roads with 20MPH speed limits. Speed limits should be evidence-led and self-explaining and seek to reinforce people’s assessment of what is a safe speed to travel. They should encourage self-compliance. Speed limits should be seen by drivers as the maximum rather than a target speed. Traffic authorities set local speed limits in situations where local needs and conditions suggest a speed limit that is lower than the national speed limit.

An informal consultation was held from 04 July 2025 until 18 July 2025 for 20MPH speed limits in the following roads in Thorpe Ward:

- Barrowsand
- Burges Close
- Burges Road (east and west of Thorpe Hall Avenue)
- Colbert Avenue
- Dungannon Chase
- Dungannon Drive
- Elm Grove
- Fermoy Road
- Johnstone Road
- Kensington Road
- Marcus Avenue
- Marcus Chase
- Marcus Gardens
- Northumberland Crescent
- Parkanaur Avenue
- Shaftesbury Avenue
- St Augustine’s Avenue
- St James Avenue
- The Broadway
- Tyrone Road
- Wyatts Drive

The roads highlighted as having the highest safety concerns were as follows: Thorpe Hall Avenue, Station Road, Maplin Way North, Maplin Way, Burges Road, Colbert Avenue, Wyatts Drive, Shaftesbury Avenue, Kensington Road.

There was a total of 412 validated responses to the consultation for 20MPH speed limits, 209 (51%) in favour and 203 (49%) against. Due to the volume of responses received against the proposals during the informal consultation period, the Council determined a scheme of that scale would not be appropriate and has now used the approach of reviewing specific areas, with the support of Ward Councillors, to identify smaller, more feasible proposals/options.

The location has been proposed to have 20MPH Speed Limits introduced, due to the high footfall of the area and high use of pedal cycles, for those (mainly children and parents) travelling to and from Greenways School.

The location has also been proposed to have 20MPH Speed Limits introduced, due to the high footfall of the area and high use of pedal cycles for those travelling to, from and around Southchurch Park.

The scheme has been designed to introduce 20MPH Speed Limits as the area does not currently have traffic calming measures such as speed humps or chicanes. 20mph limits are signed with terminal and repeater signs and do not require traffic calming. 20mph limits are like other local speed limits and normally apply to individual or small numbers of roads.

Legislation

The Southend-on-Sea City Council, in exercise of its powers under Section 84 of the Road Traffic Regulation Act 1984 ("the 1984 Act"), as and of all other enabling powers, and after consultation with the Chief Officer of Police in accordance with Part III of Schedule 9 to the Act.

All of the associated signing and lining will be in accordance with Traffic Signs Regulations and General Directions (TSRGD) 2016.

Equality Act 2010, Section 149

Consideration has been given to the equalities duty of Southend-on-Sea City Council.

Due Regard for Traffic Orders and Notices

The Southend-on-Sea City Council has a duty to give ‘due regard to’ the following three aims of the public sector equality duty (section 149 of the Equality Act 2010) during the development of the policy.

- Eliminate discrimination, harassment and victimisation and any other conduct prohibited by the Act:
- Advance equality of opportunity between people who share a protected characteristic and people who do not share it; and
- Foster good relations between people who share a protected characteristic

An initial assessment against each of the protected groups is provided below – any issues highlighted through the consultation process will be considered and reported at the end of the consultation period.

<p>Proposal</p>	<p>To introduce a 20MPH Speed Limits within:</p> <ul style="list-style-type: none"> • Kensington Road, from its junction with Shaftesbury Avenue to its junction with Northumberland Crescent • Shaftesbury Avenue, from its junction with Kensington road to its junction with Lifstan Way • Lifstan Way, from its junction with Shaftesbury Avenue to its junction with Woodgrange Drive • Northumberland Crescent, from its junction with Lifstan Way to its junction with Kensington Road.
<p>Notice/ Traffic Order Titles</p>	<p>THE SOUTHEND-ON-SEA CITY COUNCIL (VARIOUS ROADS) (MOVING TRAFFIC AND SPEED LIMIT) ORDER 2025</p> <p>THE SOUTHEND-ON-SEA CITY COUNCIL (VARIOUS ROADS) (MOVING TRAFFIC AND SPEED LIMIT) (20MPH SPEED LIMITS – SOUTHCHURCH PARK) AMENDMENT NO.* ORDER 2026</p>

Protected group	Challenge or opportunity considered and what we did
Age(A)	A positive impact on this group has been identified, as the 20MPH Speed Limits will increase the safety of children both on foot and on pedal-cycles who travel to and from Greenways Primary School and to and from Southchurch Park.
Disability (D)	No negative or positive impact on this group has been identified at this time.
Sex (S)	No negative or positive impact on this group has been identified at this time.
Race (including Gypsy & Traveller) (R)	No negative or positive impact on this group has been identified at this time.
Gender reassignment (GR)	No negative or positive impact on this group has been identified at this time.
Marriage & civil partnership (MCP)	No negative or positive impact on this group has been identified at this time.
Pregnancy & maternity (PM)	No negative or positive impact on this group has been identified at this time.
Religion and/or Belief (RAOB)	No negative or positive impact on this group has been identified at this time.
Sexual Orientation (SO)	No negative or positive impact on this group has been identified at this time.

Name: C. Read

Dated:

Signed:

Head of Highways and Coastal

Monitoring and Review

Please identify any aspects that require reconsideration following the TRO consultation process, identify any amendments made in relation to due regard and give reasoning.

Name: C. Read

Dated:

Signed:

Head of Highways and Coastal

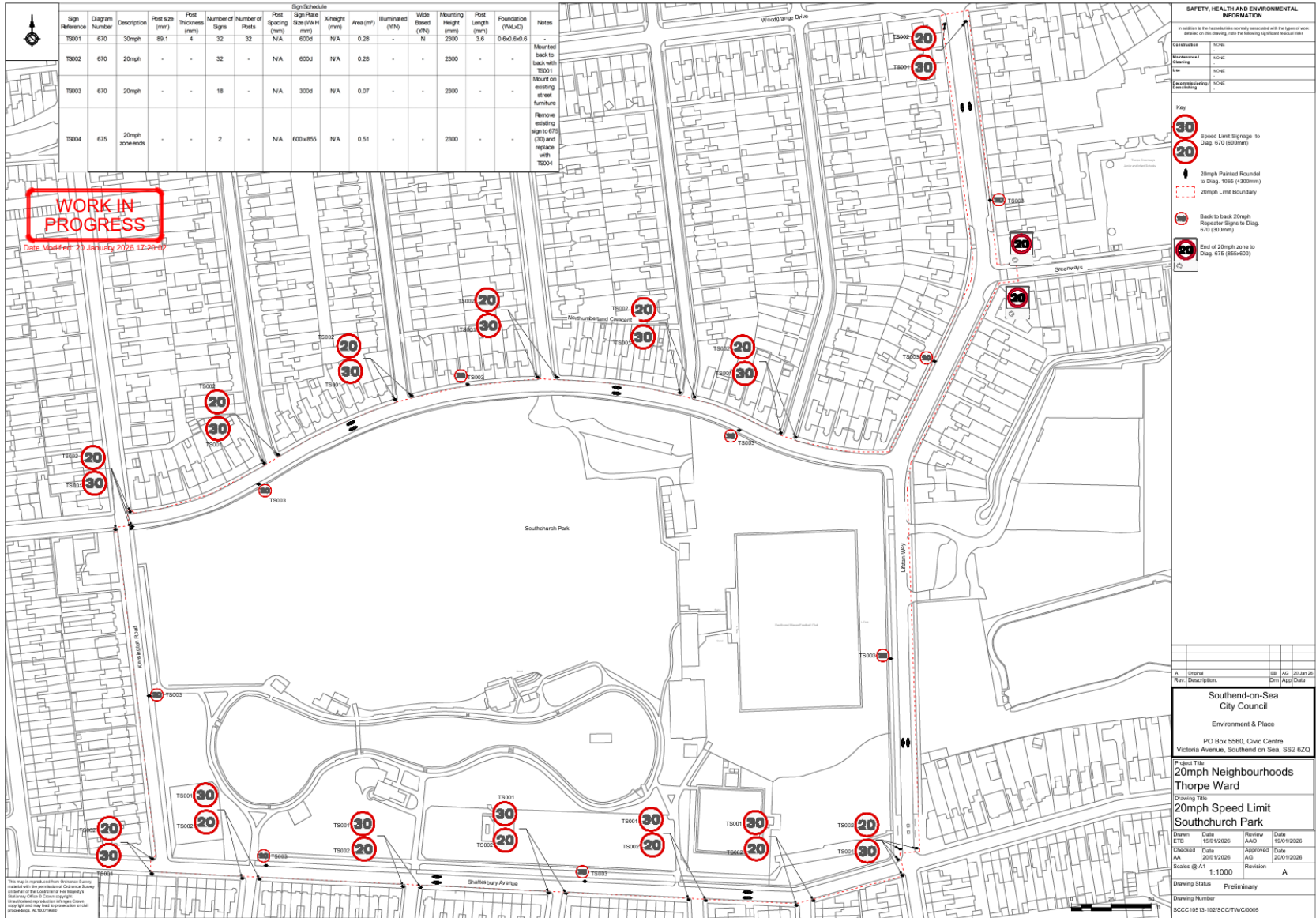

WORK IN PROGRESS
 Date Modified: 20 January 2026 17:20:02

Sign Reference	Diagram Number	Description	Post size (mm)	Post thickness (mm)	Number of Signs	Number of Posts	Sign Schedule				Illuminated (Y/N)	Wide Based (Y/N)	Mounting Height (mm)	Post Length (mm)	Foundation (W/L/D)	Notes
							Post Spacing (mm)	Sign Plate Size (WxH mm)	Sign Height (mm)	Area (m ²)						
T5001	670	30mph	89.1	4	32	32	N/A	600d	NA	0.28	-	-	2300	-	-	Mounted back to back with T5001
T5002	670	20mph	-	-	32	-	N/A	300d	NA	0.07	-	-	2300	-	-	Mount on existing street furniture
T5003	670	20mph	-	-	18	-	N/A	300d	NA	0.07	-	-	2300	-	-	Remove existing sign to 670 (30) and replace with T5004
T5004	675	20mph zone ends	-	-	2	-	N/A	600x855	NA	0.51	-	-	2300	-	-	

SAFETY, HEALTH AND ENVIRONMENTAL INFORMATION

It is noted in the Hazardous Materials associated with the types of work detailed on this drawing, note the following sign board material risks

Construction	SC02
Demolition	SC02
Cleaning	SC02
Use	SC02
Manufacturing/Overhaul	SC02

Key:

- 30** Speed Limit Signage to Class 370 (650mm)
- 20** 20mph Plaque Roundel to Diag. 1055 (430mm)
- 20** 20mph Limit Boundary
- 20** Back to back 20mph Repeater Signs to Diag. 675 (260mm)
- 20** End of 20mph zone to Diag. 675 (260mm)

A	Change	18	18	20 Jan 25
Rev	Description	20	20	19 Jan 25

Southend-on-Sea City Council
 Environment & Place
 PO Box 5560, Civic Centre
 Victoria Avenue, Southend on Sea, SS2 6ZQ

Project Title:
 20mph Neighbourhoods
 Thorpe Ward
 20mph Speed Limit
 Southchurch Park

Drawn	Date	Review	Date
ETB	15/01/2026	AAC	15/01/2026
Checked	Date	Approved	Date
JA	20/01/2026	AAC	20/01/2026
Scale	@ A1	Revision	A

Drawing Status: Preliminary
 Drawing Number: 80CC-10513-102/SC/CTWC/0005